

ANCHORING OF THE SIDE WALLS - Plasticized metal sheet

(Note: With this application, the aesthetic result will be lower).
Use aluminium or rigid PVC anchoring profiles, where possible.

"L" shaped metal band coupled with PVC

The "L" shaped metal band can be

used both on new swimming pools and in case of refurbishments.

Fix the metal band with expansion nails. The membrane will be fixed in spots and then hot-air welded on PVC coupled with metal sheet. (drawings 6-7)

5 cm fixing plate.

Fix the metal band with expansion nails. The membrane will be fixed by spots and then hot-air welded on the plate (drawing 8).

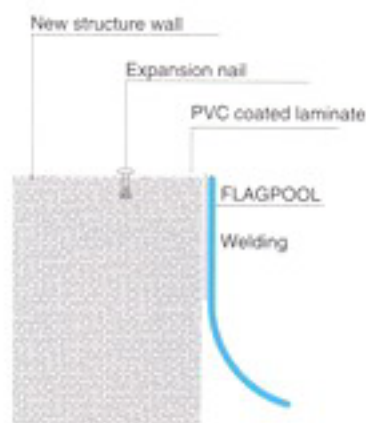

Drawing 6

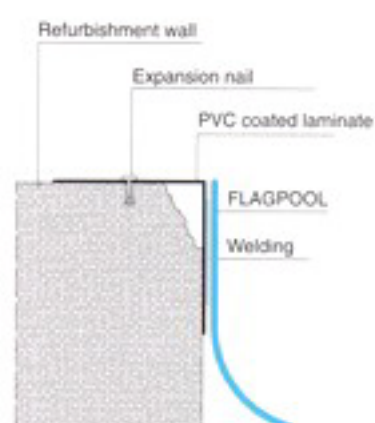

Drawing 7

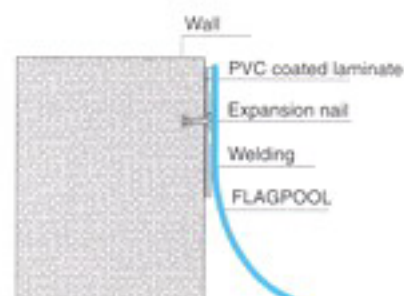

Drawing 8

